

## Grease separator *EasyClean* free Direct NS 15 – 30 for free-standing installation



EN 1825 Z-54.1-473

### Tank

Manufactured from virgin, non-recycled polyethylene, for free-standing installation in frost-protected areas, with integrated sludge trap and sloped surfaces for fast and clean disposal, with two domed covers made of polymer, with quickrelease closures, sealed odour-tight, with suction device installed for the joint disposal of contents of sludge trap and grease separator chamber, intake pipe 75 mm OD PN 10 in accordance with DIN 2501, Storz-B coupling R 2 1/2 for connection to the disposal vehicle. Inlet and outlet  $\varnothing$  200 / 250 mm for the connection to PE-HD pipes according to DIN 19537, HT pipes according to DIN 19560, PP or AS.

### Disposal System

Direct with direct disposal.

**Delivery:** System completely assembled.

- **Accessories:** Inspection window and refill inlet, sampling chamber, retrofit sets up to Auto Mix & Pump from page 23 – 25
- **Technical note** page 22
- **Installation examples** page 22 – 29



*without SonicControl*

NS	Art. no.
<i>Without accessories</i>	
NS 15	93 015.01/D
NS 20	93 020.01/D
NS 25	93 025.01/D
NS 30	93 030.01/D

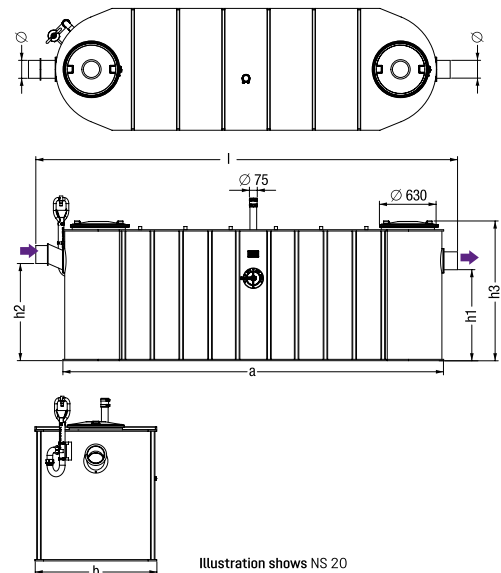

Illustration shows NS 20

NS	$\varnothing$	a	Installation dimension l × b	h1	h2	h3	Sludge trap	Water and sludge	Grease storage	Total (incl. water)
15	200	3300	3560 × 1350	1130	1200	1625	1500 l	1100 l	600 l	2600 l
20	200	4250	4510 × 1350	1030	1100	1525	2000 l	1370 l	800 l	3370 l
25	200	4500	4760 × 1350	1030	1100	1525	2500 l	1200 l	1000 l	3700 l
30	250	4600	4860 × 1350	1170	1240	1655	3000 l	1370 l	1200 l	4370 l

EN 1825 Z-54.1-473

$\varnothing$  = Outer diameter