

New products

# Grease separators

**KESSEL**

Grease separator

## *EasyClean ground oval*

the space saving solution  
as a single dome grease separator



Made in Germany

Leading in drainage

## Grease separators *EasyClean* ground oval

The space-saving solution  
for underground installation.

Underground installation outside the building is a space saving alternative to indoor installed separators. Here, we offer a wide range of grease separators with the *EasyClean* ground oval that combines the advantages of the *EasyClean* free with more usable operating space.



- 1 Grease separator
- 2 Height adjustable upper section
- 3 Disposal chamber
- 4 Pumping station

**EasyClean ground oval**  
complete includes tank, upper  
section, cover, gaskets



**Lock & Lift**  
lockable odour tight manhole cover  
with easy release technology

**Fully certified according to EN**  
600 mm access by health and  
safety – all installation depth  
provides easy service/inspection

**Upper sections**  
vertical adjustable



**Warranty**  
KESSEL offers a factory extended  
warranty of 20 years on the  
polyethylene grease separator tanks.

**Cable conduit**  
water/odour tight chamber  
sealing system for Sonic-Control  
sensor cable



**Groundwater resistance**  
up to manhole cover

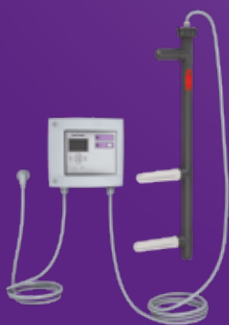

**SonicControl**  
for the measurement, display and  
control of the grease layer thickness  
includes clip-on installation bracket

# Grease separator *EasyClean* ground oval Direct NS 1 – 12,5 for underground installation



EN 1825 DIN 4040-100

The separator for greasy wastewater is suitable for installation in the ground and comes without metallic components in the tank. The collecting tank made of permanently resistant polymer (PE) is equipped with an integrated sludge trap and has a rounded base for fast and clean disposal. Access for cleaning and maintenance work is possible via a service access cover. A direct disposal pipe socket is available for manual disposal. A load distribution slab must be installed on site for load class D. The reinforcement drawings are part of the EBA and are available from KESSEL AG. The tank is groundwater resistant up to ground level (GL). 20 year polyethylene warranty.

➤ **Accessories:** Sampling chamber, extension section, *SonicControl* page 6

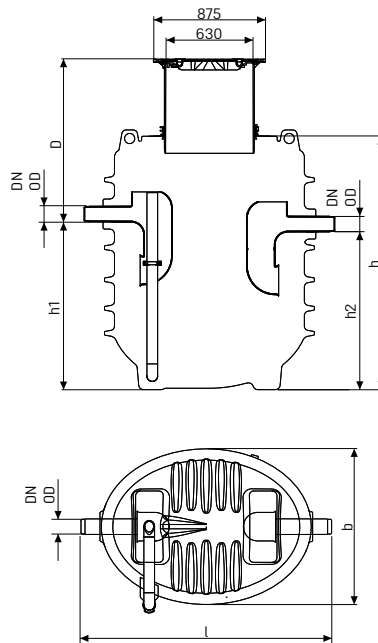

**Technical note**  
Weather-related influences or cooling of the tanks during the installation phase (caused by filling with cold water) can lead to deviations in dimensions from the catalogue specifications in the case of cisterns and separators installed in the ground.

NS	Ø (mm)	l (mm)	b (mm)	h (mm)	h1 (mm)	h2 (mm)	Weight (kg)	Sludge trap (l)	Water and grease (l)	Grease storage (l)	Total (l)
1	110	1700	1090	1515	870	800	215	100	550	40	650
2	110	1700	1090	1515	870	800	215	200	450	80	650
3	110	1700	1090	1820	1175	1105	230	300	615	120	915
4	110	1700	1090	1820	1175	1105	230	400	515	160	915
7	160	1870	1090	2375	1705	1635	305	700	930	280	1630
8,5	160	1870	1090	2375	1755	1685	305	850	850	340	1700
10	160	1870	1090	2795	2170	2100	345	1000	1100	400	2100
12,5	200	1870	1090	2795	2135	2065	350	1250	880	500	2130

Ø = Outer diameter D = Installation depth

## Underground installation frost-free depth 1200 mm

NS	Installation depth D in mm	Direction of flow "left" Art. no.	Direction of flow "right" Art. no.
----	----------------------------	-----------------------------------	------------------------------------

### Cover class B

NS 1	690 - 1190	95 010-120B-DL	95 010-120B-DR
NS 2	690 - 1190	95 020-120B-DL	95 020-120B-DR
NS 3	690 - 1190	95 030-120B-DL	95 030-120B-DR
NS 4	690 - 1190	95 040-120B-DL	95 040-120B-DR
NS 7	715 - 1215	95 070-120B-DL	95 070-120B-DR
NS 8,5	665 - 1165	95 085-120B-DL	95 085-120B-DR
NS 10	670 - 1170	95 100-120B-DL	95 100-120B-DR
NS 12,5	645 - 1145	95 125-120B-DL	95 125-120B-DR

### Cover class D, with Lock & Lift function

NS 1	900 - 1190	95 010-120D-DL	95 010-120D-DR
NS 2	900 - 1190	95 020-120D-DL	95 020-120D-DR
NS 3	900 - 1190	95 030-120D-DL	95 030-120D-DR
NS 4	900 - 1190	95 040-120D-DL	95 040-120D-DR
NS 7	925 - 1215	95 070-120D-DL	95 070-120D-DR
NS 8,5	875 - 1165	95 085-120D-DL	95 085-120D-DR
NS 10	880 - 1170	95 100-120D-DL	95 100-120D-DR
NS 12,5	855 - 1145	95 125-120D-DL	95 125-120D-DR

## Underground installation frost-free depth 1700 mm

NS	Installation depth D in mm	Direction of flow "left" Art. no.	Direction of flow "right" Art. no.
----	----------------------------	-----------------------------------	------------------------------------

### Cover class B

NS 1	1040 - 1740	95 010-170B-DL	95 010-170B-DR
NS 2	1040 - 1740	95 020-170B-DL	95 020-170B-DR
NS 3	1040 - 1740	95 030-170B-DL	95 030-170B-DR
NS 4	1040 - 1740	95 040-170B-DL	95 040-170B-DR
NS 7	1065 - 1765	95 070-170B-DL	95 070-170B-DR
NS 8,5	1015 - 1715	95 085-170B-DL	95 085-170B-DR
NS 10	1020 - 1720	95 100-170B-DL	95 100-170B-DR
NS 12,5	995 - 1740	95 125-170B-DL	95 125-170B-DR

### Cover class D, with Lock & Lift function

NS 1	1190 - 1740	95 010-170D-DL	95 010-170D-DR
NS 2	1190 - 1740	95 020-170D-DL	95 020-170D-DR
NS 3	1190 - 1740	95 030-170D-DL	95 030-170D-DR
NS 4	1190 - 1740	95 040-170D-DL	95 040-170D-DR
NS 7	1215 - 1765	95 070-170D-DL	95 070-170D-DR
NS 8,5	1165 - 1715	95 085-170D-DL	95 085-170D-DR
NS 10	1170 - 1720	95 100-170D-DL	95 100-170D-DR
NS 12,5	1145 - 1695	95 125-170D-DL	95 125-170D-DR



# Grease separator *EasyClean* ground oval Standard NS 1 – 12,5

for underground installation



EN 1825 DIN 4040-100

The separator for greasy wastewater is suitable for installation in the ground and comes without metallic components in the tank. The collecting tank made of permanently resistant polymer (PE) is equipped with an integrated sludge trap and has a rounded base for fast and clean disposal. Access for cleaning and maintenance work is possible via a service access cover. A direct disposal pipe socket is available for manual disposal. A load distribution slab must be installed on site for load class D. The reinforcement drawings are part of the EBA and are available from KESSEL AG. The tank is groundwater resistant up to ground level (GL). 20 year polyethylene warranty.

➤ **Accessories:** Sampling chamber, extension section, *SonicControl* (NS 2 and NS 4) page 6

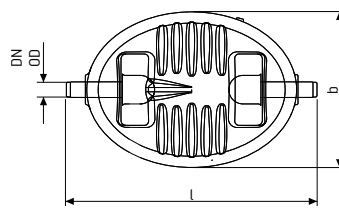
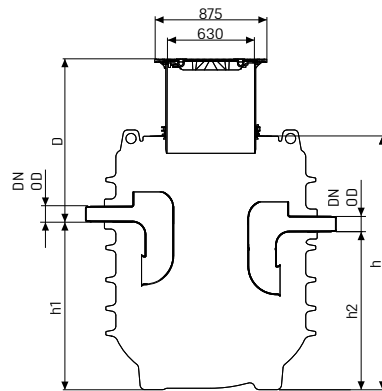

### Technical note

Weather-related influences or cooling of the tanks during the installation phase (caused by filling with cold water) can lead to deviations in dimensions from the catalogue specifications in the case of cisterns and separators installed in the ground.

NS	Ø (mm)	l (mm)	b (mm)	h (mm)	h1 (mm)	h2 (mm)	Weight (kg)	Sludge trap (l)	Water and grease (l)	Grease storage (l)	Total (l)
1	110	1700	1090	1515	870	800	215	100	550	40	650
2	110	1700	1090	1515	870	800	215	200	450	80	650
3	110	1700	1090	1820	1175	1105	230	300	615	120	915
4	110	1700	1090	1820	1175	1105	230	400	515	160	915
7	160	1870	1090	2375	1705	1635	305	700	930	280	1630
8,5	160	1870	1090	2375	1755	1685	305	850	850	340	1700
10	160	1870	1090	2795	2170	2100	345	1000	1100	400	2100
12,5	200	1870	1090	2795	2135	2065	350	1250	880	500	2130

Ø = Outer diameter D = Installation depth

### Underground installation frost-free depth 1200 mm

NS	Installation depth D in mm	Art. no.
<b>Cover class B</b>		
NS 1	690 - 1190	95 010-120B
NS 2	690 - 1190	95 020-120B
NS 3	690 - 1190	95 030-120B
NS 4	690 - 1190	95 040-120B
NS 7	715 - 1215	95 070-120B
NS 8,5	665 - 1165	95 085-120B
NS 10	670 - 1170	95 100-120B
NS 12,5	645 - 1145	95 125-120B

### Cover class D, with Lock & Lift function

NS 1	900 - 1190	95 010-120D
NS 2	900 - 1190	95 020-120D
NS 3	900 - 1190	95 030-120D
NS 4	900 - 1190	95 040-120D
NS 7	925 - 1215	95 070-120D
NS 8,5	875 - 1165	95 085-120D
NS 10	880 - 1170	95 100-120D
NS 12,5	855 - 1145	95 125-120D

### Underground installation frost-free depth 1700 mm

NS	Installation depth D in mm	Art. no.
<b>Cover class B</b>		
NS 1	1040 - 1740	95 010-170B
NS 2	1040 - 1740	95 020-170B
NS 3	1040 - 1740	95 030-170B
NS 4	1040 - 1740	95 040-170B
NS 7	1065 - 1765	95 070-170B
NS 8,5	1015 - 1715	95 085-170B
NS 10	1020 - 1720	95 100-170B
NS 12,5	995 - 1740	95 125-170B

### Cover class D, with Lock & Lift function

NS 1	1190 - 1740	95 010-170D
NS 2	1190 - 1740	95 020-170D
NS 3	1190 - 1740	95 030-170D
NS 4	1190 - 1740	95 040-170D
NS 7	1215 - 1765	95 070-170D
NS 8,5	1165 - 1715	95 085-170D
NS 10	1170 - 1720	95 100-170D
NS 12,5	1145 - 1695	95 125-170D



## Accessories

Grease separators for underground installation

### SonicControl level sensing system

#### Level sensing system

**Compatibility:** For grease separators for underground installation

**Inclusive:** Ultra sonic sensor for electronic measurement, display and control of the grease layer thickness and the water temperature; power connection, battery back up, connection for remote speaker; installation set with easy assembly and maintenance; control unit with optical and audible alarm with potential free contact; electronic log book with 12 month capacity. Data transfer by telemetry.

**Voltage:** 230 V ~ 50 Hz

**Protection type:** IP 54

**Plug:** Schuko 1.5 m

**Cable length:** 10 m (extendable on-site to 60 meters)



Art. no.

917 821

### Cable extension set for SonicControl FA

#### 10 m extension

#### 20 m extension

#### 30 m extension

extendable on-site to 60 meters



Art. no.

917 871

917 872

917 873

### Sampling chamber Ø 450

#### Cover class A

**Compatibility:** For connection to outlet pipe of separators for underground installation

**Installation depth (D):** 950 - 1300 mm

**Drop height:** 160 mm

**Inclusive:** Telescopic upper section with clamping ring, cover class A/B/D, sealed odour-tight

**Extension:** 600 mm with extension section Art. no. 915 402

#### Cover class B

#### Cover class D

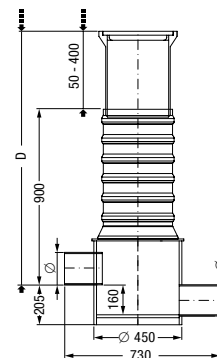

In-/Outlet

Art. no.

Ø 110

915 881A

Ø 160

915 882A

Ø 200

915 883A

Ø 260

915 884A

Ø 110

915 881B

Ø 160

915 882B

Ø 200

915 883B

Ø 260

915 884B

Ø 110

915 881D

Ø 160

915 882D

Ø 200

915 883D

Ø 260

915 884D

### Extension section

#### Extension section

**Compatibility:** For sampling chamber Ø 400 and Ø 450

**Extension height:** max. 600 mm (can be shortened on-site)

**Check maintenance accessibility!**

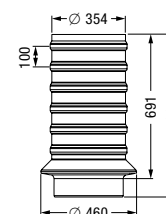

Art. no.

915 402



## Grease separators

# *EasyClean* ground oval

Individual solutions possible

The new EasyClean ground oval can also be used for some technical solutions like a cleaning or a disposal system which can be used combined by the same submerged pump. By using the waste water for cleaning clean water can be saved. An overground or inbuilding installation for the control unit and the electric valve lead to several solutions for the installation. All technical parts can be taken out of the tank for an easy maintenance.

More information or another solution on request: [individual@kessel.de](mailto:individual@kessel.de)





For further information visit  
[www.kessel.com](http://www.kessel.com)



Subject to technical modifications.

**KESSEL AG**

Bahnhofstraße 31 • 85101 Lenting, Germany

[www.kessel.com](http://www.kessel.com)